

# HOME pro

cabinets to go



**Come with a  
vision, leave with  
a kitchen**



**In-Stock program for do-it-yourself  
home owners, renovators & contractors**

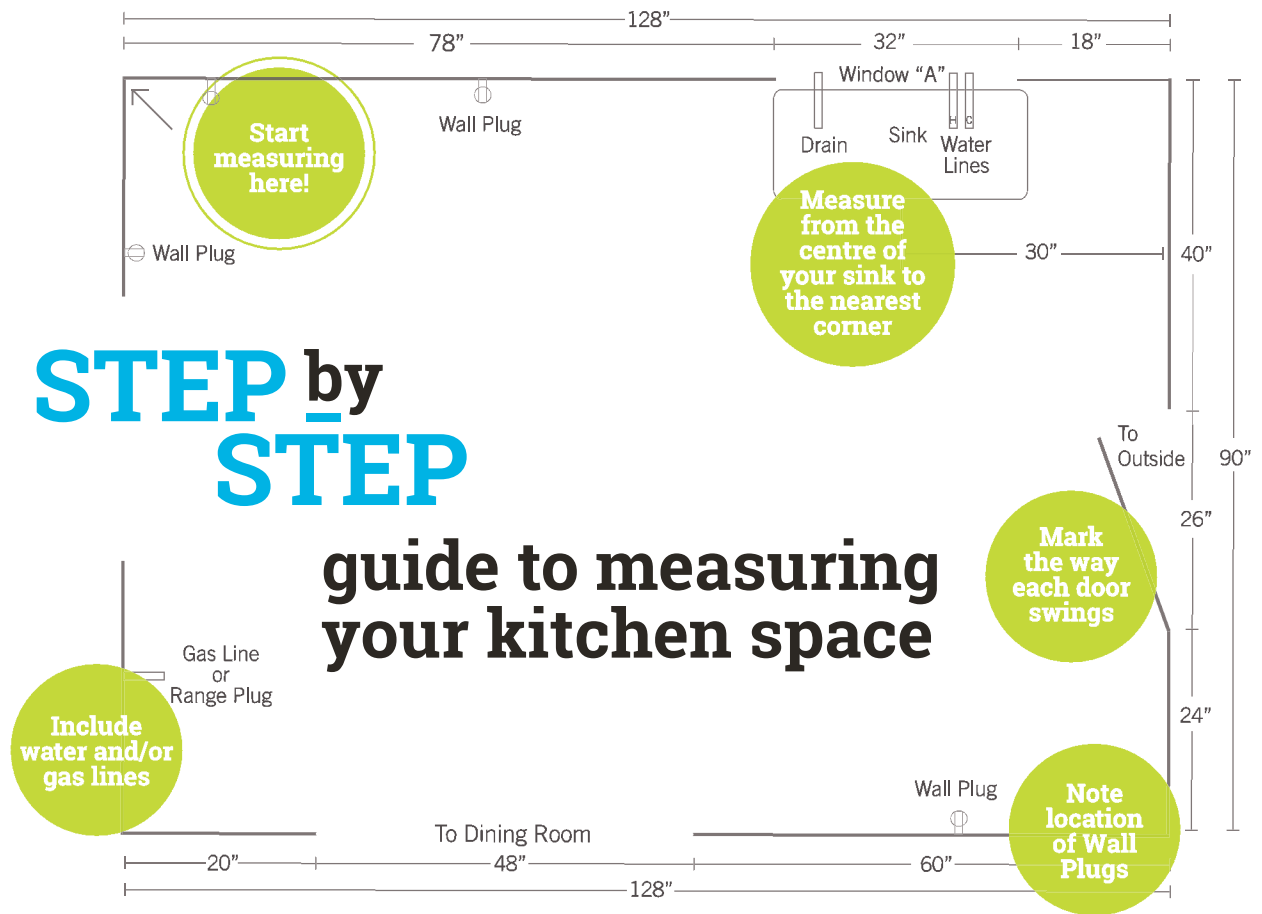

Include ALL the following information on the Grid Sheet provided

1. Start measuring from the corner shown in the drawing.
2. Measure total length of all walls corner to corner.
3. Indicate the location and sizes of the **doors and windows**.
4. Include individual corner to window/door sill dimensions.
5. Indicate **door swings** and location of the **electrical plugs** and the **center line of sink**. Include **waterline** and **floor drain locations**.
6. Confirm the **room height** and location of **drop ceiling** and **bulk heads**.
7. Indicate **appliance locations** and sizes.
8. **Double check all the dimensions** - individual and totals.
9. **Take photos** with your cell.

**DON'T FORGET TO DOUBLE CHECK THE DIMENSIONS**

| Appliance Chart |       |        |       |
|-----------------|-------|--------|-------|
|                 | Width | Height | Depth |
| Fridge          | _____ | _____  | _____ |
| Range           | _____ | _____  | _____ |
| Dishwasher      | _____ | _____  | _____ |
| Sink            | _____ | _____  | _____ |
| Microwave       | _____ | _____  | _____ |
| Other           | _____ | _____  | _____ |
|                 | _____ | _____  | _____ |
|                 | _____ | _____  | _____ |
|                 | _____ | _____  | _____ |
|                 | _____ | _____  | _____ |



# PRODUCT list

## BASE CABINETS

34 5/8" high  
24" deep

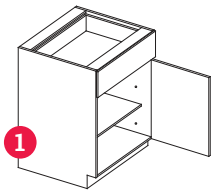

B9, B12, B15,  
B18, B21

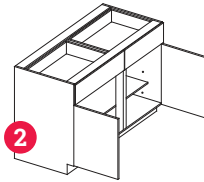

B24-2, B27,  
B30, B33, B36

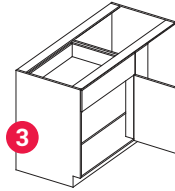

BCL4218, BCR4218

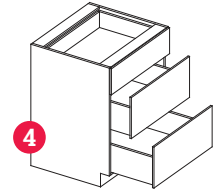

BD153V,  
BD213V

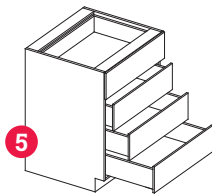

BD184V, BD244V

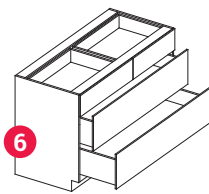

BD304S

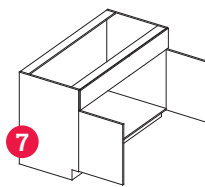

SB24-2, SB30,  
SB33, SB36

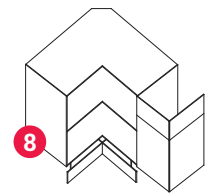

BCCQ33FH,  
BCCQ36FH

## TALL CABINETS

84" high  
24" deep

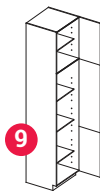

T182484

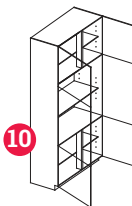

T2484-2, T3084

The freedom to bring your style home. This guide provides you with a wide variety of our ready to install cabinetry. We make it easy to bring functional and stylish storage into your space.

## WARRANTY

We offer a one year manufacture defects warranty on all of our in-stock cabinets.

## VANITY CABINETS

31 5/8" high  
21" deep

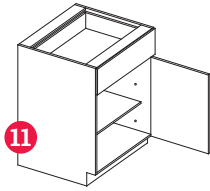

V12, V15, V18

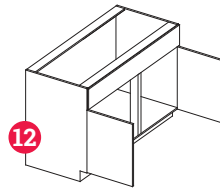

SV24-2, SV27, SV30,  
SV33, SV36

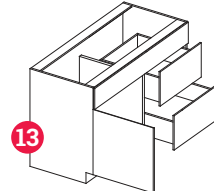

SVDR30, SVDL30,  
SVDR36, SVDL36

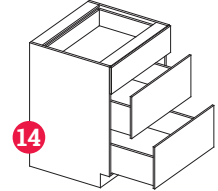

VD123V, VD153V,  
VD183V

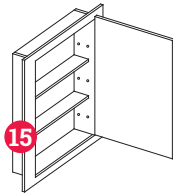

VWF13.524

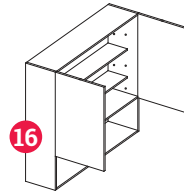

VWWM2433-2

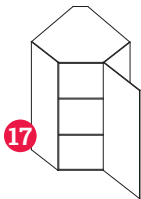

WA2430

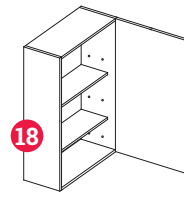

W930, W1230, W1530,  
W1830, W2130

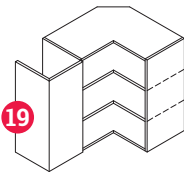

WCC2130

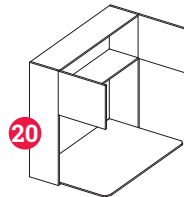

WM2430-15,  
WM2730-10.5

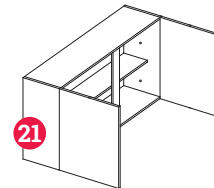

W3013.5, W3315,  
W3615, W2418-2,  
W3018, W3318,  
W3024, W3324,  
W3624, W2430-2,  
W2730, W3030,  
W3330, W3630

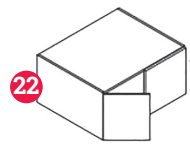

W3315.524  
W3615.524

## ACCESSORIES

Corner and "T" Moulds  
Crown Moulding  
Cutlery Tray  
Hardware  
Light Valance  
Panels  
Round Waste Bin  
Screws and Washers  
Spice Tray  
Spin Trays Pie cut  
Towel Rod  
Tray Dividers

## WALL CABINETS

30" high  
12 5/8" deep



Quality, convenience and style provide our customers with outstanding value.

**QUALITY**

Our Canadian made cabinets are both doweled and glued, with boxes and drawer boxes constructed of cabinet grade white melamine. Cabinets come with upgraded full extension drawer box system complete with soft close hardware on both doors and drawer boxes.

**CONVENIENCE**

Fully assembled.  
Ready to install.  
Next day pick up.

**STYLE**

Our team of designers are here to assist you with your design and layout.

## Assembled & ready to install



Custom Ordering Available

**HOME**pro  
cabinets to go

**STORE HOURS:**  
Monday-Friday, 8:30 am - 4:30 pm

**WAREHOUSE HOURS FOR PICKUP:**  
Monday-Friday, 9:00 am - 4:00 pm

**DELIVERY SERVICE AVAILABLE**